

CITY OF GALENA, ILLINOIS

101 Green Street, Galena, Illinois 61036



REQUEST FOR QUOTE

Turner Hall Stage Curtains and Hardware

DUE DATE: 10 AM, Tuesday, November 16, 2021

TO: LIST
FROM: Janelle Keeffer, Facilities Manager
DATE: October 20, 2021
SUBJECT: Turner Hall Stage Curtains | Request for Quote

INTRODUCTION AND GENERAL INFORMATION

The City of Galena is requesting quotes for new stage curtains, hardware, and a cyclorama for Turner Hall, a historic theater and community hall built in 1874. www.turnerhall.com
The Hall is located at 115 South Bench Street, Galena, Illinois.

Installation is not included in this request for quote.

Questions or requests for site visits or photos may be directed to Janelle Keeffer, Facilities Manager, Galena City Hall. jkeeffer@cityofgalena.org; 815-777-1050; 101 Green Street, Galena, IL 61036.

SCOPE OF PROJECT

Job Detail	Description	Quote
Job Detail BASE BID Hanging hardware to replace current dog chain and S-hooks	(42) proof coil chain points, for wraparound strut at top, and wraparound pipe/attach to clamps on track...including bridles where already existing.	\$
New Hardware	(7) Proof coil chain points with strut top, attach to bi-parting, rope operated track for new traveler.	

Job Detail	Description	Quote
Drapery Package Front, Main Curtain 21 oz Plateau IFR Velour All other curtains, legs, and travelers 16 oz Plateau IFR Velour	<p>All curtains, borders, legs, and travelers listed will be inherently flame retardant.</p> <p>(2) Main Curtain Panels, standard traveler, each not to exceed 17'-8"x23'-4" (HxW), 21 oz Plateau IFR Velour, 50% fullness, standard color TBD (probably a shade of red or burgundy); final vendor to provide color choices—will likely be a standard shade of red / burgundy. <i>These travelers will replace our current guillotine front curtain.</i></p> <p>(3) Borders, each 6'x44' (HxW), Plateau IFR Velour, 50% fullness, black</p> <p>(2) Legs, each 17'-8"x10' (HxW), Plateau IFR Velour, 50% fullness, black, chain-weighted bottom</p> <p>(2) Legs, each 17'-8"x9' (HxW), Plateau IFR Velour, 50% fullness, black, chain-weighted bottom</p> <p>(2) Legs, each 17'-8"x8' (HxW), Plateau IFR velour, 50% fullness, black, chain weighted bottom</p> <p>(2) Travelers, each 17'-8"x23'-4" (HxW), Plateau IFR Velour, 50% fullness, black, chain-weighted bottom</p>	\$
ADDER: Main Curtain Lining	Black IFR Avora lining fabric.	\$
ADDER: Walk-along Track	Add (2) 10' pieces of natural color walkalong track for one of the 9' leg pairs- complete with all necessary operational accessories, including pipe clamps for 1-1/2' SCH40 pipe	\$
ADDER: Seamless Bleached Natural Muslin Cyclorama with Track	44' ADC 173 for one way draw, natural color with trim chains and 8 pipe clamps and cyclorama--seamless Natural color muslin, treated for flame retardancy, sewn flat, with grommet and tie top and chain and pipe pocket bottom	\$

Job Detail	Description	Quote
DELIVERY / SHIPPING	Standard shipping to Turner Hall, 115 South Bench Street, Galena, IL 61036 (no dock). If semi-trailer is used for shipping, please notify for alternate special delivery instructions and location.	\$
INSTRUCTION & SUPPORT	Installation instructions, consulting, and a maintenance / inspection schedule are required to be provided. We plan to have our maintenance team install the rigging and curtains. Also advise on care and cleaning of the curtains, any ongoing maintenance to retain flame retardancy, and any required scheduling for inspection for any / all components. Please advise standard estimated completion date / turn time.	\$

CONDITIONS

The City of Galena shall be exempt from any liability for costs incurred by unsuccessful bidders in preparation for this proposal.

The City of Galena is tax exempt.

The City of Galena will receive sealed lump sum quotes to complete the proposed work until **10:00 AM, Tuesday, November 17, 2021.**

The City of Galena will make payment within thirty (30) days after acceptance of the completed work.

The City of Galena reserves the right to reject any or all quotes.

We advise that any prospective contractor visit the project site as part of their assessment. Any questions should be directed to: Facilities Manager Janelle Keeffer at 815-777-1050.

LIST:

Chicago Flyhouse, Inc.
2925 W. Carroll Avenue
Chicago, IL 60612
773-584-4510

Gopher Stage Lighting
4141 Cedar Avenue S
Minneapolis, MN 55407
612-871-0138 x 113
Cherie Gallinati

Grand Stage
3418 N. Knox Avenue
Chicago, IL 60641
312-332-1605
Michael Hostetler

Benjamin Cohen

Galena's Historic Turner Hall | Photos & Floor / Lighting Plans





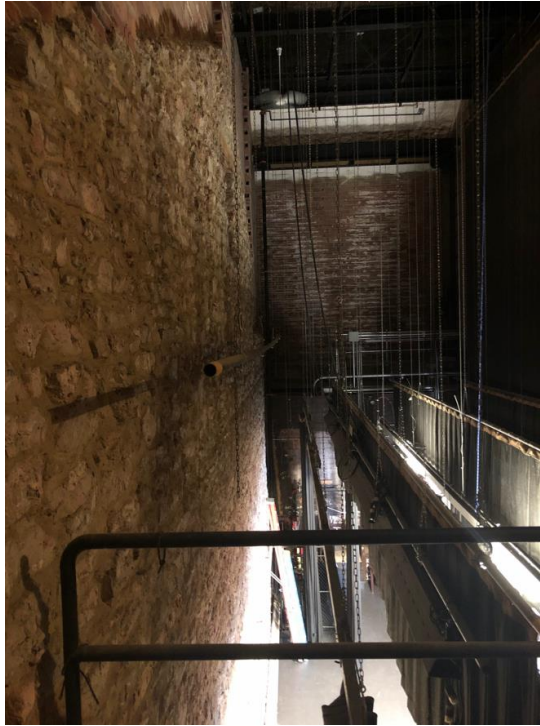



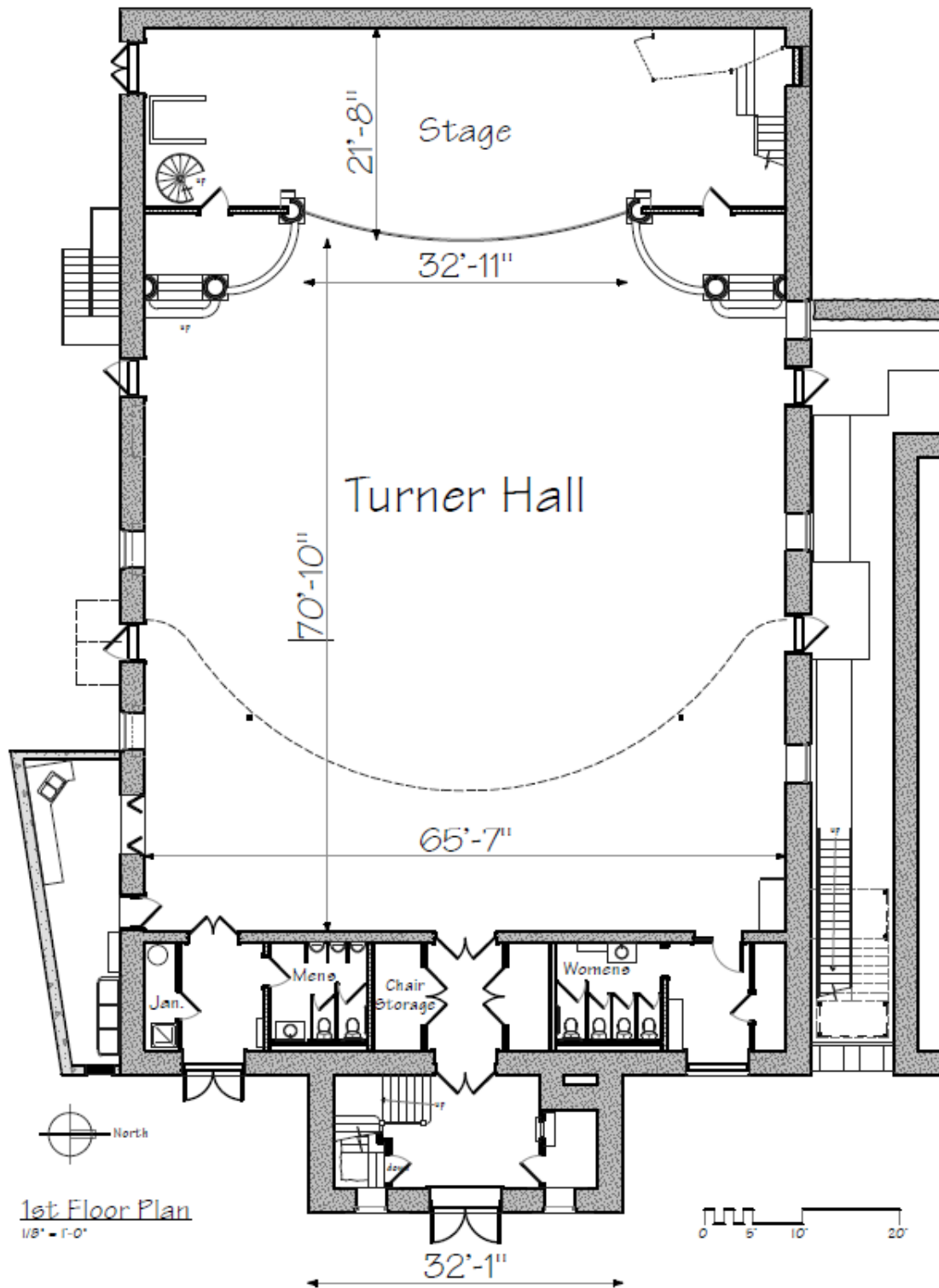

Standard Instrument Locations and Settings

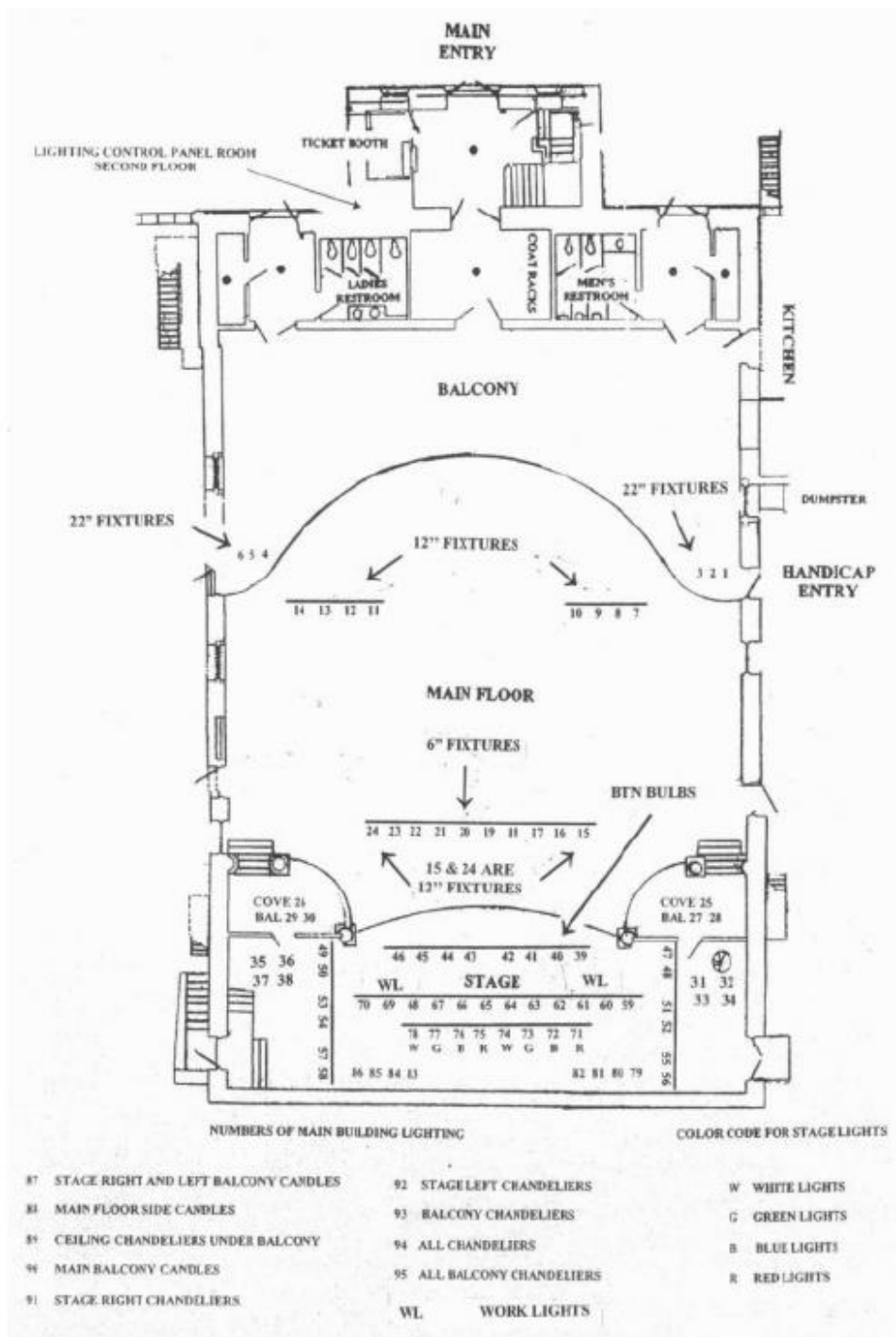

Turner Hall Owned by the City of Galena Illinois turnerhall.com